

Tube-Line Accelerator Spinner Kit

Operator's Manual

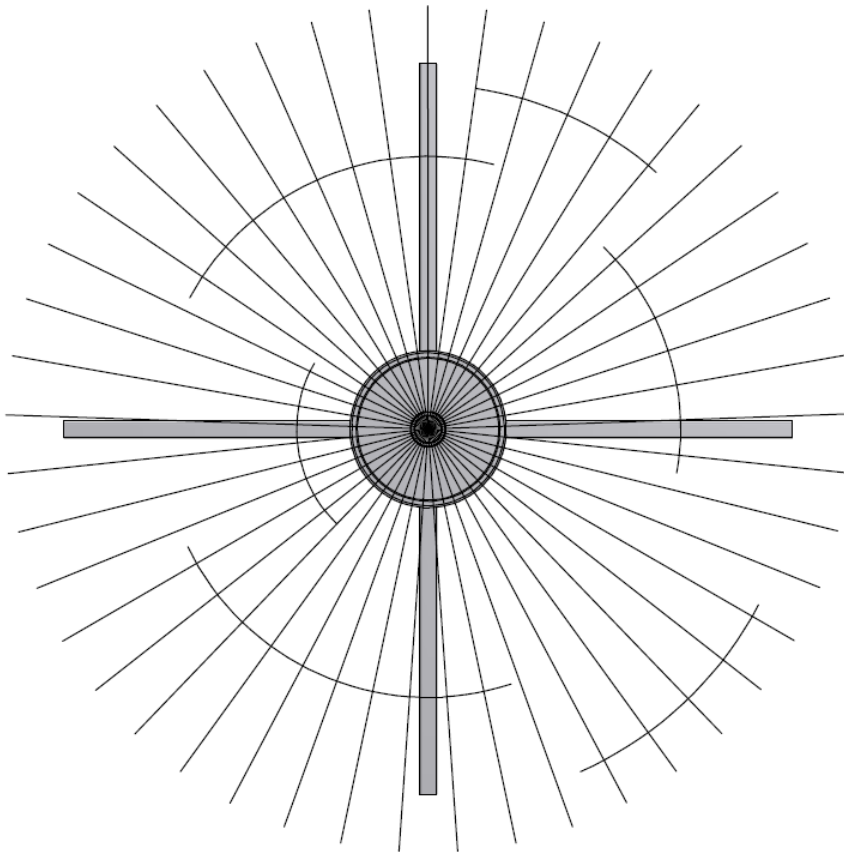

TO THE OWNER

This manual contains information concerning the adjustment, assembly and maintenance of your Tube-Line Spinner Kit. You have purchased a dependable machine, but only by proper care and operation can you expect to receive the performance and long life built into the Spinner Kit. Please have all operators read this manual carefully and keep it available for ready reference.

Your authorized dealer will instruct you in the general operation of your Spinner Kit. Your dealer's staff of factory-trained service technicians will be glad to answer any question that may arise regarding the operation of your Spinner Kit.



WARNING



This safety alert symbol indicates important safety messages in this manual. When you see this symbol, carefully read the message that follows and be alert to the possibility of personal injury or death.



WARNING



Pictures in this manual may show protective shielding open or removed to better illustrate a particular feature or adjustment.

Be certain, however, to close or replace all shielding before operating the machine

Improvements

Tube-Line Manufacturing Inc. is continually striving to improve its products. We reserve the right to make improvements or changes when it becomes practical and possible to do so, without incurring any obligation to make changes or additions to the equipment sold previously.

Contents

Safety.....	5
Parts	15
General information.....	34
Operation.....	40
Lubrication	42
Maintenance.....	44
Troubleshooting.....	45

Precautionary Statements

Personal Safety

Throughout this manual and on machine decals you will find precautionary statements (“DANGER”, “WARNING”, and “CAUTION”) followed by specific instructions. These precautions are intended for the personal safety of you and those working with you. Please take time to read them.



CAUTION



This word “DANGER” indicates an immediate hazardous situation that, if not avoided, will result in death or serious injury.



WARNING



This word “WARNING” indicates a Potentially Hazardous situation that, if not avoided, could result in death or serious injury.



DANGER



This word “CAUTION” indicates a potentially hazardous situation that, if not avoided, may result in minor or moderate injury. It may also be used to alert against unsafe practices. Failure to follow the danger warning and caution instructions may result in serious bodily injury or death.

MACHINE SAFETY

The precautionary statement (“important”) is followed by specific instructions. This statement is intended for machine safety.

IMPORTANT: The word “*IMPORTANT*” is used to inform the reader of something he needs to know to prevent minor machine damage if a certain procedure is not followed.

SAFETY

PRECAUTIONARY STATEMENTS

A careful operator is the best operator. Most accidents can be avoided by observing certain precautions. To help prevent accidents read the following precautions before operating this equipment. Equipment should be operated only by those who are responsible and instructed to do so.

Carefully review the procedures given in this manual with all operators. It is important that all operators be familiar with and follow safety precautions.

1. Before operating the unit be sure that it is assembled correctly and in good operating condition.
2. If machine maintenance work, repairs or adjustments must be done in the field, they should be done at a spot where the ground is firm and level. Turn off the tractor and apply the parking brake. Use the proper tools and wear suitable protection (safety goggles, work gloves, etc.).
3. If any maintenance work, repairs or adjustments are done which require disassembly, always make sure that everything is reassembled or retightened as it has been prior to making repairs or adjustments.
4. Follow the schedule provided for maintenance. By following these suggestions, it will be possible to keep the machine operating safely and efficiently, to the benefit of the user.
5. General checking of bolts, security pins and split pins must be carried out initially after the first 8 hours of use. Subsequently, check every 50 hours and whenever the machine is laid up for extended periods.
6. Before applying pressure to the system, be sure all connections are tight and that hoses and connections are not damaged.
7. Fluid under pressure can have sufficient force to penetrate the skin, causing serious personal injury. Always protect the skin and eyes from escaping fluid under pressure. If injured by escaping fluid, obtain medical assistance at once. Serious infection or reaction can develop if medical treatment is not administered immediately.
8. Before leaving the cab, engage the parking brake, shut down engine, and wait for all moving parts to stop.
9. Always keep bystanders away from machine during operation. Rotating elements may cause serious bodily injury.

General Safety

YOU are responsible for the safe operation and maintenance of your Tube-line Chainless Bale Feeder. You must ensure that you and anyone else who is going to operate, maintain or work around the Bale Feeder be familiar with the operating and maintenance procedures and related safety information contained in this manual.

Remember, YOU are the key to safety. Good safety practices not only protect you but also the people around you. Make these practices a working part of your safety program. Most accidents can be prevented. Do not risk injury or death by ignoring good safety practices. Review the operating instructions for this header at least once a year per OSHA regulations 1928.57. Know the meaning and location of each decal before operating the BF5000.

Watch for this symbol in this manual and on the Bale Feeder:



1. Keep a first aid kit in the cab for emergencies and know how to use it.
2. Do not allow any one to ride on the Bale Feeder while it is in motion.
3. Clear the area of bystanders, especially small children before starting the Bale Feeder.
4. Do not allow anyone to operate the Bale Feeder who has not been instructed in how to use the machine.
5. All operators should familiarize themselves with the safety section in the operator's manual.
6. Some pictures or illustrations may not show protective shields in place. Make certain that all protective shields are in place before operating the machines.

Operating and Maintenance Safety

1. DANGER, DO NOT stand around or near the Discharge or bed area. Objects thrown from the beaters may cause death or serious injury
2. Hydraulic leaks can penetrate the skin causing serious injuries. Small leaks can be invisible and are the most dangerous. Use some object, like cardboard, to find the leak. Do not use your hand.

Hydraulic Safety

Ensure that all the pressure is released from the hydraulic lines before repairing.
Replace or repair damaged hoses immediately.



WARNING



When checking for oil leaks use a piece of cardboard; DO NOT use your hand:

Escaping fluid under pressure can penetrate the skin causing serious injury.
Avoid the hazard by relieving pressure before disconnecting hydraulic of other lines.
Tighten all line connections before applying pressure.
Protect hands and body from high-pressure fluids.

If an accident occurs, see a doctor immediately. Any fluid injected into the skin must be surgically removed within a few hours or gangrene may result. Doctors unfamiliar with this type of injury should reference a knowledgeable medical source. Failure to comply could result in death or serious injury.

Operating and Maintenance safety

1. DANGER, DO NOT stand around or near the Spinners. Objects thrown from the Spinners may cause death or serious injury.
2. Do not operate the Tubeline Spreader Kit in crowded or confined areas.
3. Hydraulic leaks can penetrate the skin causing serious injuries. Small leaks can be invisible and are the most dangerous. Use some object, like cardboard, to find the leak. Do not use your hand.
4. Ensure that all the pressure is released from the hydraulic lines before repairing.
Replace or repair damaged hoses immediately

Section 1

Assembly Information

Approximately ½ hr assembly each Spreader Kit

NOTE : Assembly drawings are intended for use of replacement part only, and not as an assembly guide.

NOTE : Assembly drawings are placed in sequential order, as one would assemble, if desired part on drawing is shown already assembled you have gone too far, and must look at the previous drawing.

Items with your Tube-Line Spreader Kit

1. Tube-Line Spreader Assembly (2pcs)
2. 3/8 UNC Lock Nut (22pcs)
3. 5/16 UNC x 2.25 Hex bolt (2pcs)
4. 5/16 Lock Nut (2pcs)
5. Hose Clamp Assembly (2pcs)
6. Hose with Pioneer Coupler 132" long (2pcs)
7. Hydraulic Hoses 86" Long (2pcs)
8. T Fitting (2pcs)
9. 3/8 UNC x 1 Hex Bolt (22pcs)
10. T Bracket (1pc)
11. Hydraulic Hoses 74" Long (2pcs)

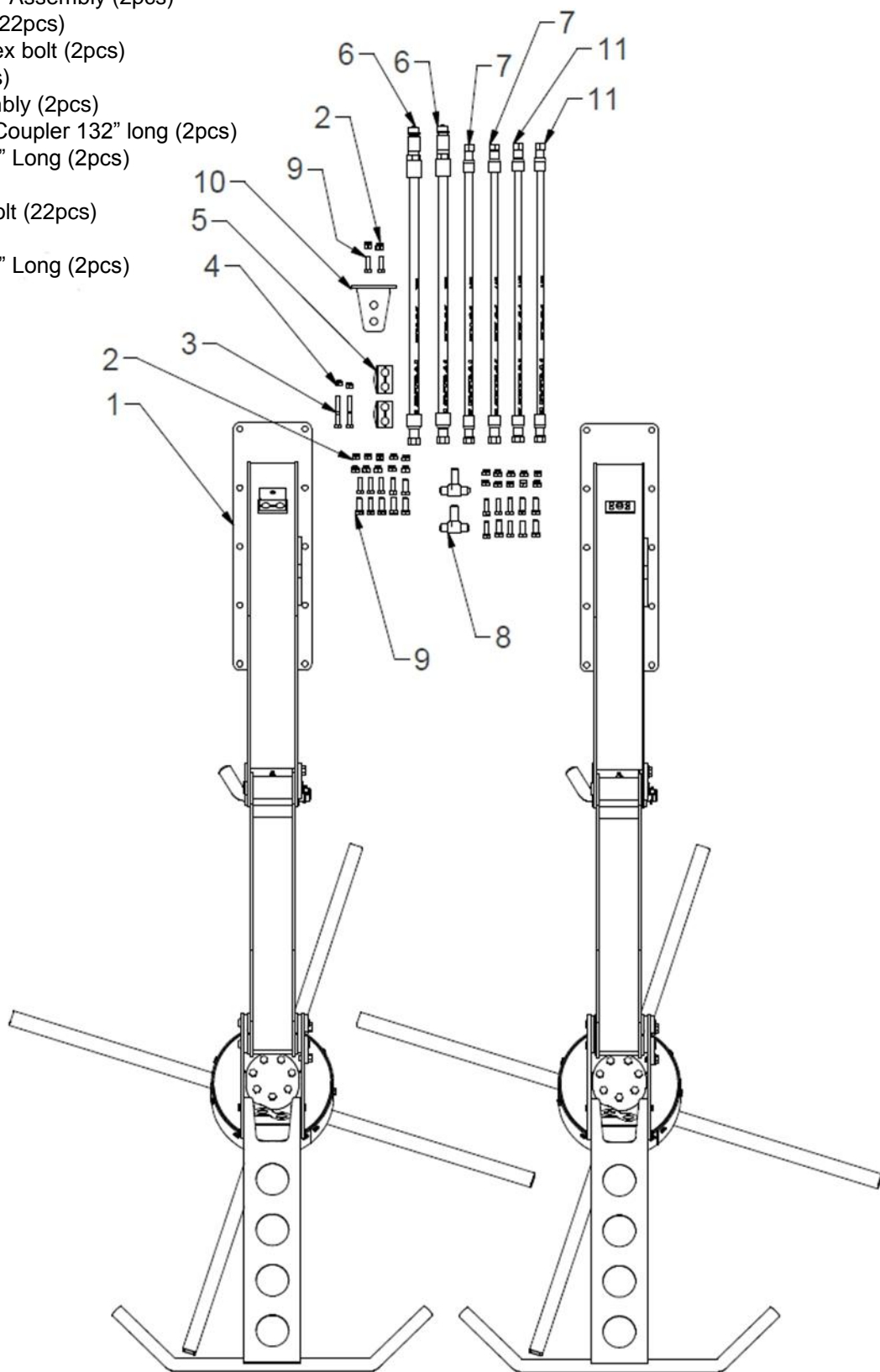

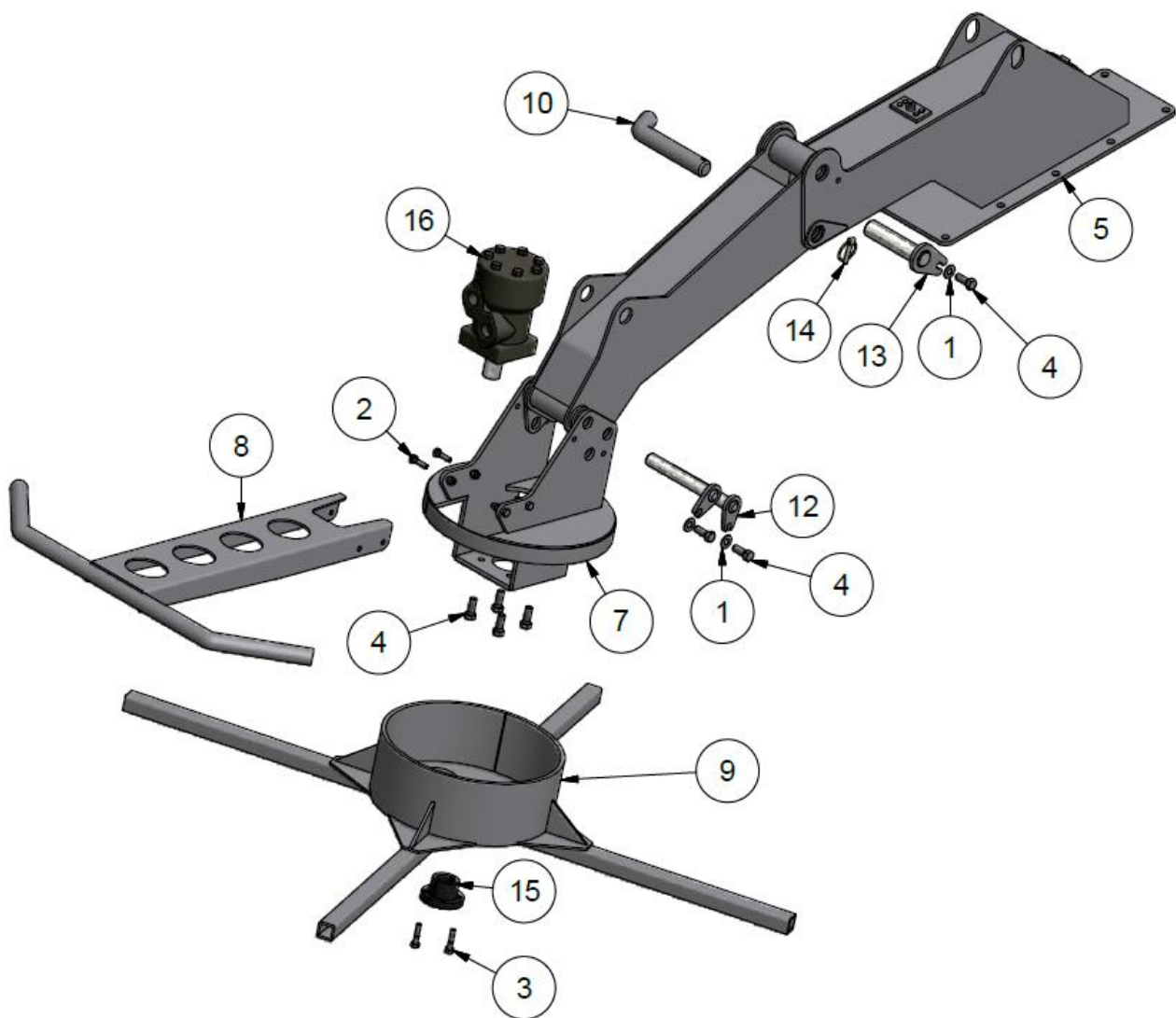

Item	Qty	Part #	Description
1	3	FW 3/8	Flat Washer
2	4	HB 1/4 X 1	Hex Bolt
3	2	HB 1/4 X 1.25	Hex Bolt
4	7	HB 3/8 X 1	Hex Bolt
5	1	HC-SK-02	Base Assembly
6	1	HC-SK-03	Arm Assembly
7	1	HC-SK-04	Motor Housing
8	1	HC-SK-05	Guard
9	1	HC-SK-06	Spinner Assembly
10	1	HC-SK-023	Pin
11	4	LN 1/4	Lock Nut
12	2	PA-00750-05375-01-01	Pin Assembly
13	1	PA-01000-04500-01-01	4.5 Pin Assembly
14	1	PP-00139	1/4" Lynch Pin
15	1	PP-00314	Taper Bushing 1" ID
16	1	PP-00742	Hydraulic Motor MS 80

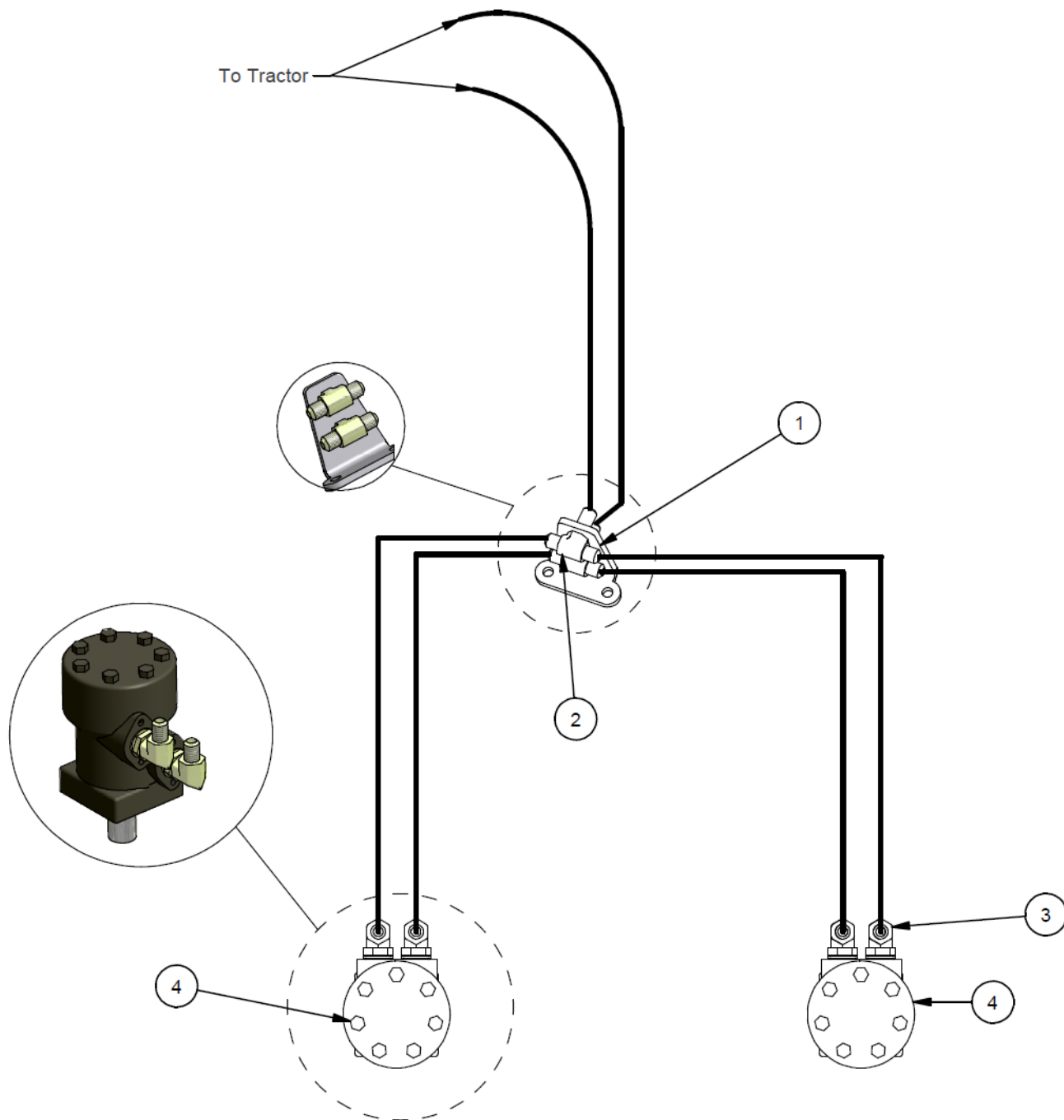

Item	Qty	Part #	Description
1	1	HC-SK-024	Hose T Mount
2	2	PP-00781	Run Tee #6M-JIC/ #6M-JIC/ #6M-JIC
3	4	PP-00615	90 6 M-JIC/ 10-M-ORB
4	2	PP-00742	Hydraulic Motor, MS 80

Parts List			
ITEM	QTY	PART NUMBER	DESCRIPTION
1	1	PP-00099	1/4" Two wire braid hose 88" long
2	2	PP-00123	Coupling, #6 F-JIC x 1/4" bore



A B

Parts List			
ITEM	QTY	PART NUMBER	DESCRIPTION
1	1	PP-00099	1/4" Two wire braid hose 88" long
2	2	PP-00123	Coupling, #6 F-JIC x 1/4" bore



C D

Parts List			
ITEM	QTY	PART NUMBER	DESCRIPTION
1	1	PP-00099	1/4" Two wire braid hose 74" long
2	2	PP-00123	Coupling, #6 F-JIC x 1/4" bore



Parts List			
ITEM	QTY	PART NUMBER	DESCRIPTION
1	1	PP-00099	1/4" Two wire braid hose 74" long
2	2	PP-00123	Coupling, #6 F-JIC x 1/4" bore



E F

Parts List			
ITEM	QTY	PART NUMBER	DESCRIPTION
3	1	PP-00094	Coupling, #6 F-JIC 3/8" bore
4	1	PP-00098	3/8" Two wire braid hose 132" long
5	1	PP-00616	Coupling #8 M-NPT, 3/8 Bore
6	1	PP-00661	Pioneer Male Coupler, #8 F-NPT



Parts List			
ITEM	QTY	PART NUMBER	DESCRIPTION
3	1	PP-00094	Coupling, #6 F-JIC 3/8" bore
4	1	PP-00098	3/8" Two wire braid hose 132" long
5	1	PP-00616	Coupling #8 M-NPT, 3/8 Bore
6	1	PP-00661	Pioneer Male Coupler, #8 F-NPT

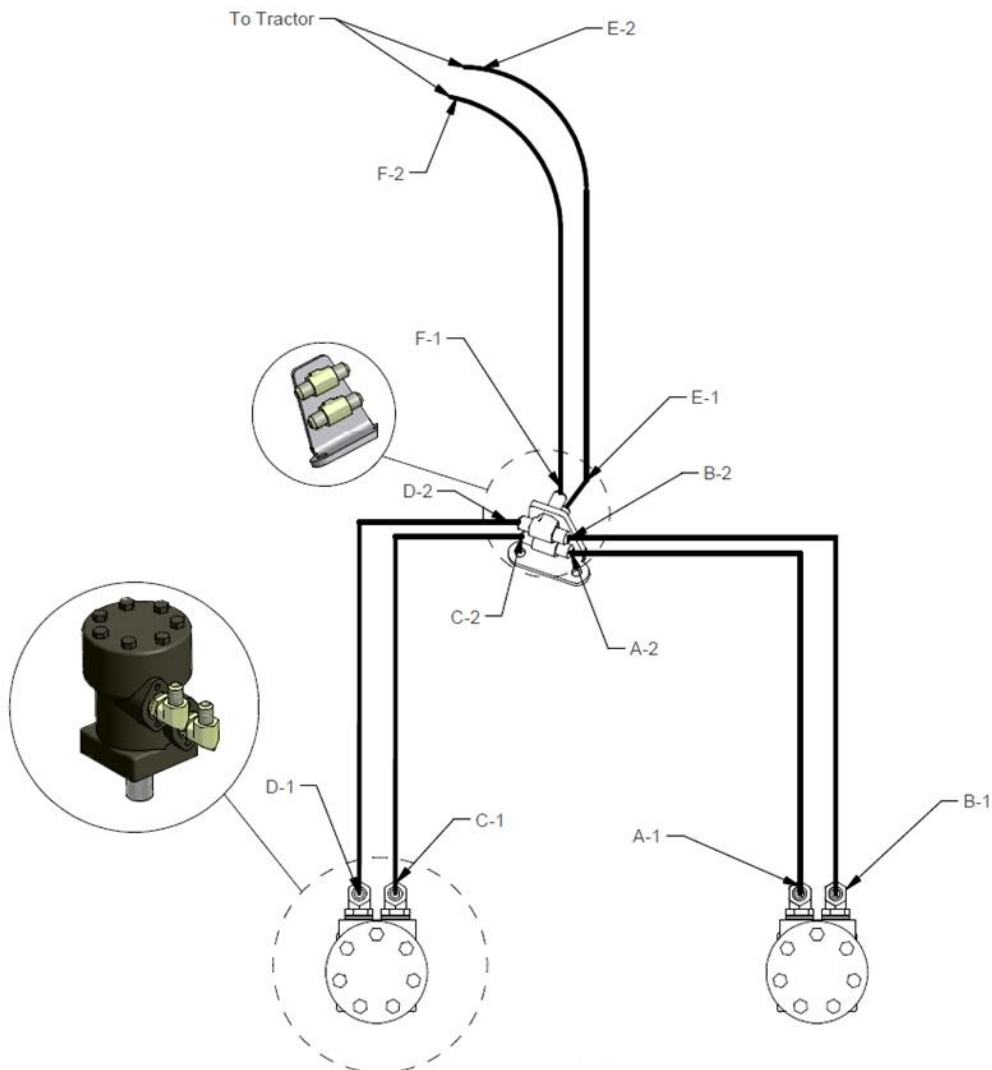
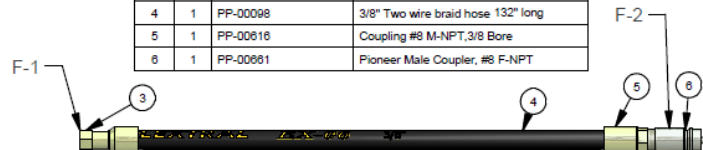

Section 2

General Information

Spreader Kit Mounting

These mounting instructions will help you mount your Spreader Kit onto the Accelerator in an easy and safe manner. Follow the instructions in the given order, or possible difficulties may arise.

Spreader Terminology

Base Plate
Lock Hole

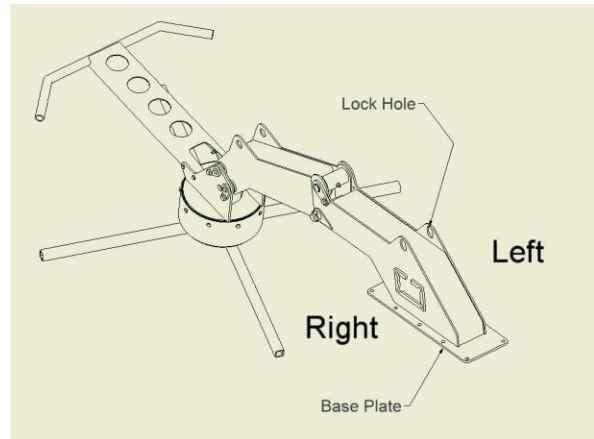

Spreader

The Spreader Kit is mounted mainly on the Tubeline Accelerator hay conditioner and is operated by hydraulic pressure from the tractor. The hydraulic motor's power the spinners. The spinners spread crop material, making it possible for the crop to dry in less time.

Principle Components

1. Base Assembly
2. Arm Assembly
3. Motor Housing
4. Guard
5. Spinner Assembly
6. Set Pin
7. Hydraulic Motor

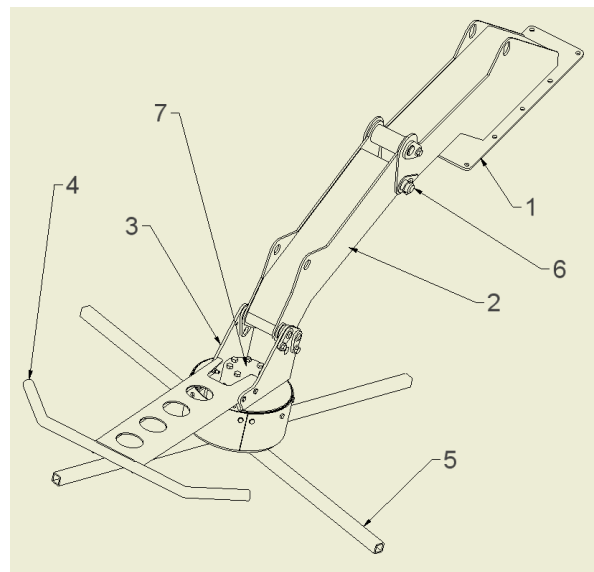

Production Identification

The pin stamped on the metal tag, 1 is located on the right side of the Base Assembly.

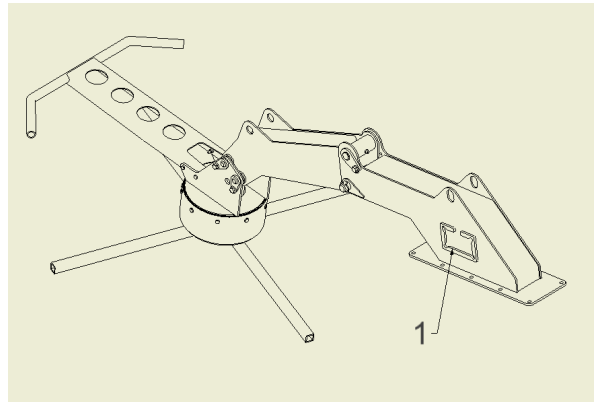

Initial Setup

1. Align the holes on the Tubeline Spreader Kit with the holes on the top of the Accelerator, and secure with 3/8 x 1" bolts and lock nuts.

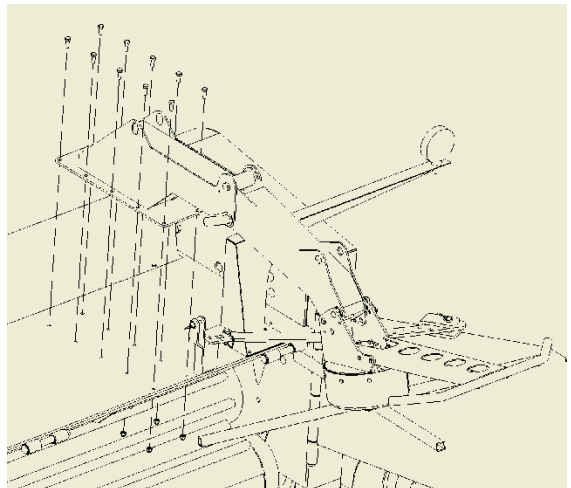
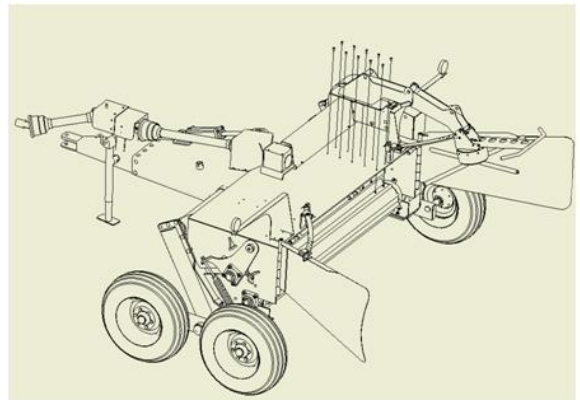

2. Drill and bolt T bracket to Accelerator at point (2), using 3/8 x 1.5" bolt and lock nut

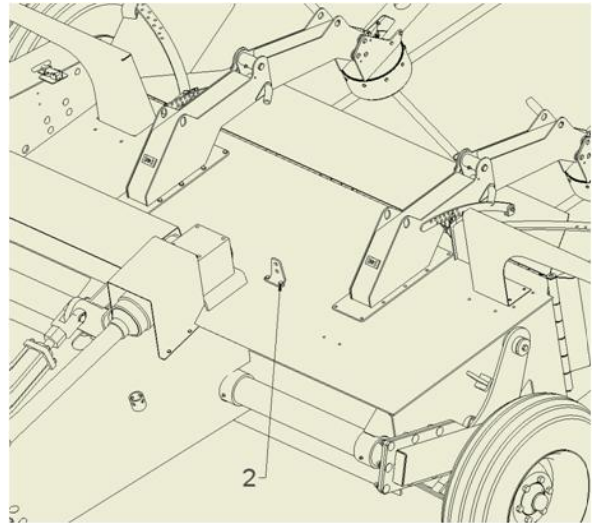

3. Drill and bolt hose clamps at point (3), using 5/16 x 2.25" bolt and lock nut.

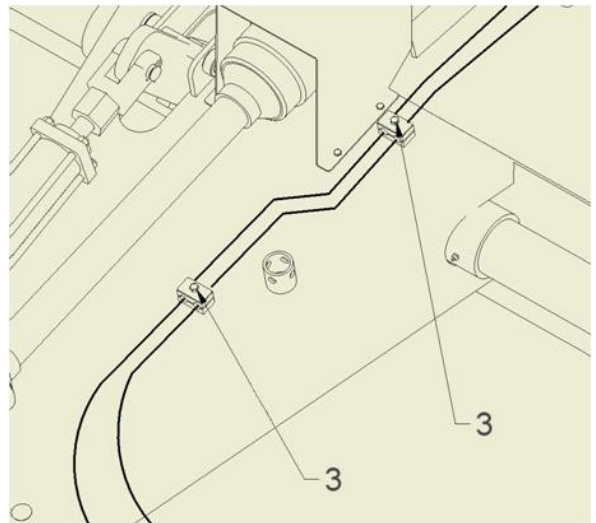

Hydraulic Assembly

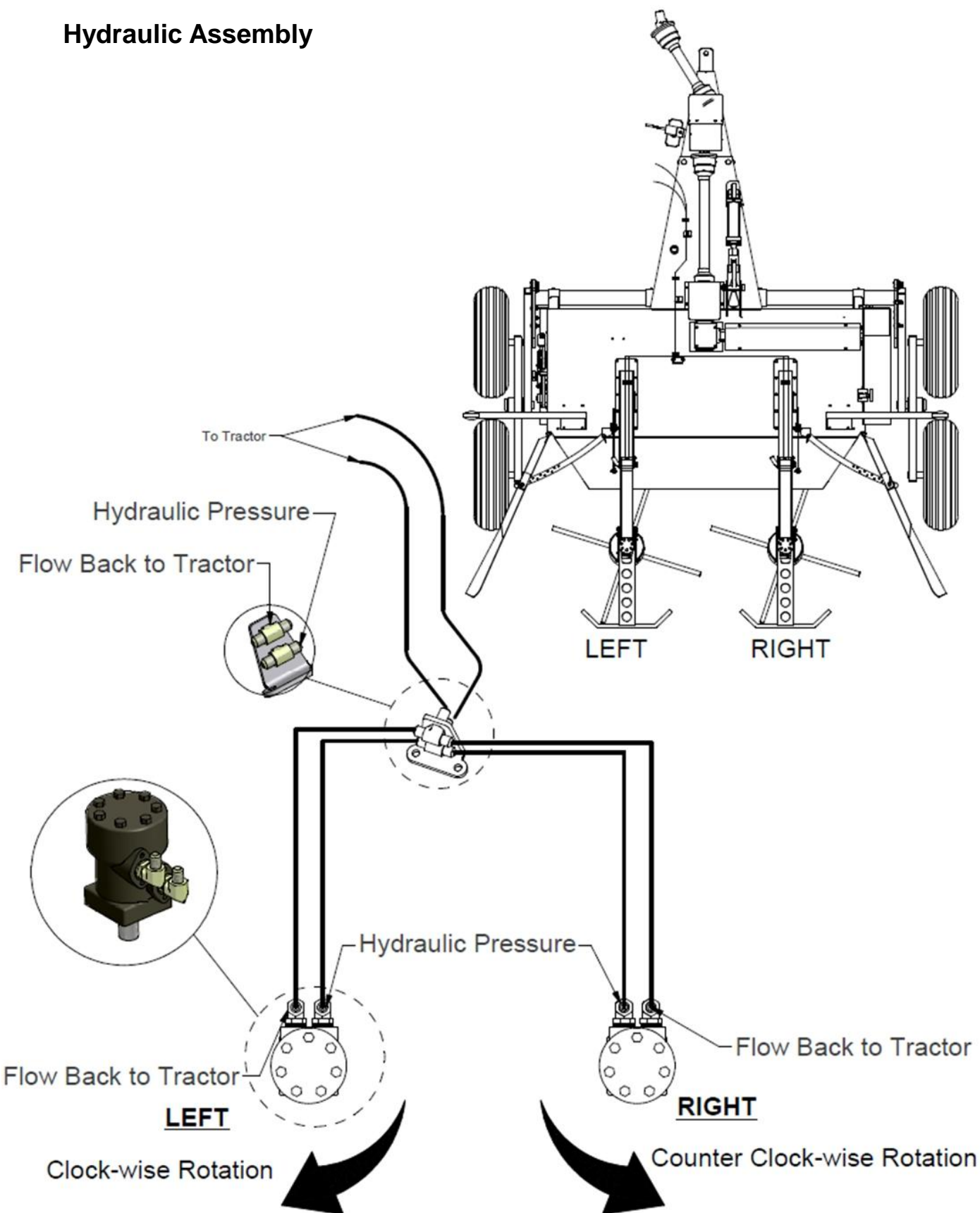

A B



C D



E F

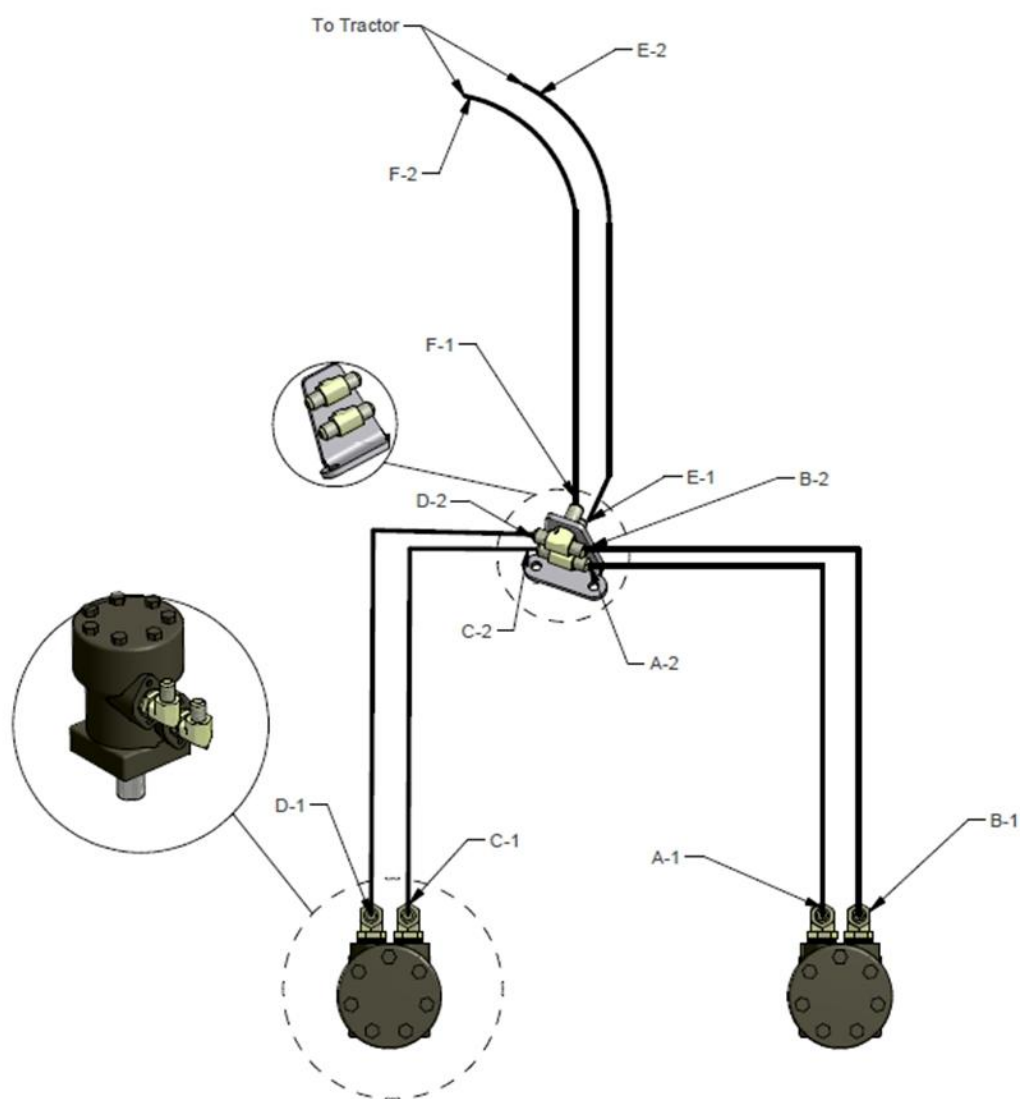

Setting up your Tube-Line Spreader Kit



WARNING



Never attempt to adjust, repair or work on Tube-Line Spreader Kit when they are rotating. Shut off tractor, engage parking brake, and remove key, wait until all moving parts have stopped before exiting the cab. Failure to comply could result in death or serious injury.

NOTE: Setup instructions assume the operator already has read and has mounted his Spreader Kit to the Tube-Line Accelerator.

[illegible]

1. To retract or to extend the Tube-Line Spreader Kit simply pull lock pin, and insert into one of the two lock locations. Either in the retracted position or in the extended position.

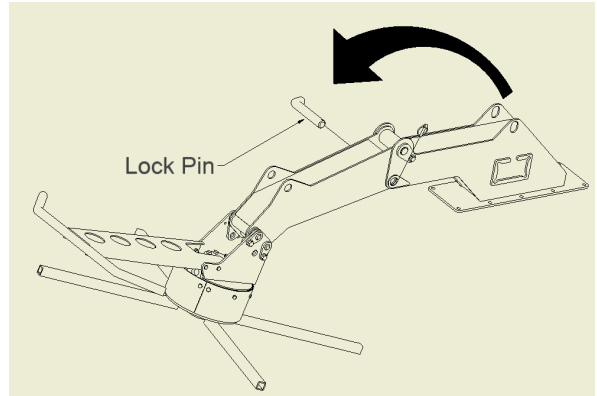

Retracted Position >>>>>>>>>>>

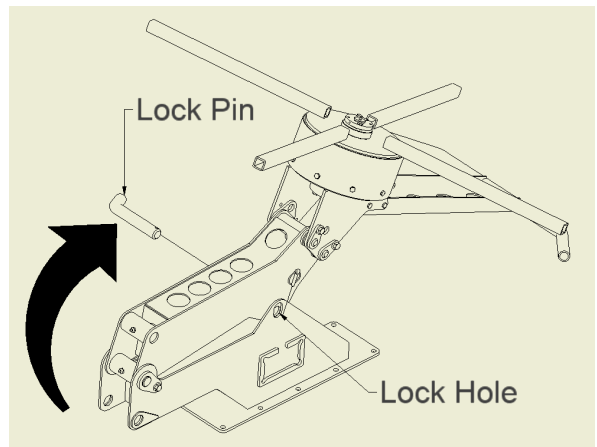

2. To set your Tube-Line Spreader Kits spread angle remove Pin Assembly and set to one of the two locations.

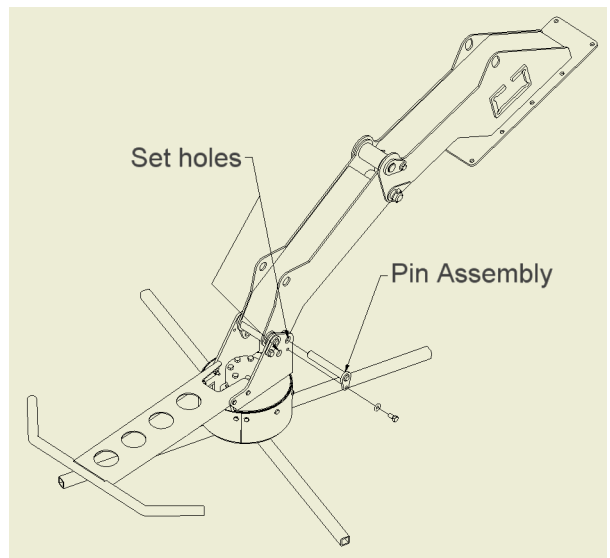

Before Transporting

1. Do a complete walk-around visual check to be sure there are no loose parts or components.
2. Do a visual check of all hoses to make sure they are securely tied so they will not pinch or drag during transporting.

Section 3 Operation

Initial Startup



WARNING



Keep bystanders away from the machine, and never make adjustments when spinners are rotating. Failure to comply could result in death or serious injury.

NOTE: Setup instructions assume the operator already has read and has mounted his Spreader Kit to the Accelerator.

1. Check to make sure all bolts are tight and Spreader Kit is in the extended position, with lock pin in place.
2. Apply hydraulic pressure to Spreader Kit
3. Check for loose or missing nuts and bolts. Tighten any that are loose and replace any missing fasteners.
4. Make sure all protective shields are in place, and properly secured.
5. Check all hydraulic hoses and fittings to be sure they are tight and that no hose damage has occurred during mounting. Repair or replace any damaged parts before starting the machine.



WARNING



Do not run machine with defective hoses or fittings. Make sure that there is no pressure in the hydraulic lines before checking or repairing. High-pressure hydraulics can cause death or serious injury



WARNING



Always keep a safe distance away from the spreader while it is running. Failure to comply could result in injury or death.

6. Restart the Tube-line Spreader Kit.

Section 4 Lubrication

Introduction

This section gives full details of the procedures necessary to maintain the Spreader Kit at peak efficiency. Complete all checks and services in this section at the hour interval shown.

Important: Failure to complete the required maintenance at the intervals shown can cause unnecessary downtime. The recommended lubrication intervals are for average condition. Perform lubrication more often when operating under adverse conditions.



Before lubricating the Spreader Kit, always observe the following precautions:

- Turn off tractor, set parking brake, remove key and wait for all moving parts to stop before leaving cab.

Failure to comply could result in death or serious injury.

Bottom grease boss

Apply 3 strokes of grease every 100 hours, at point (1).

Top grease boss

Apply 3 stroke of grease, every 100 hours, at point (2)

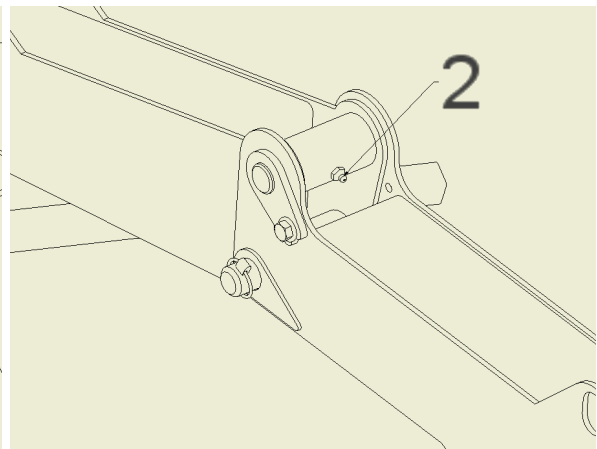
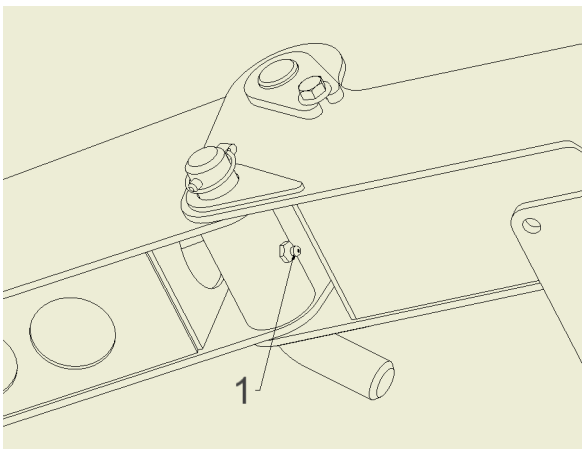

Grease Points

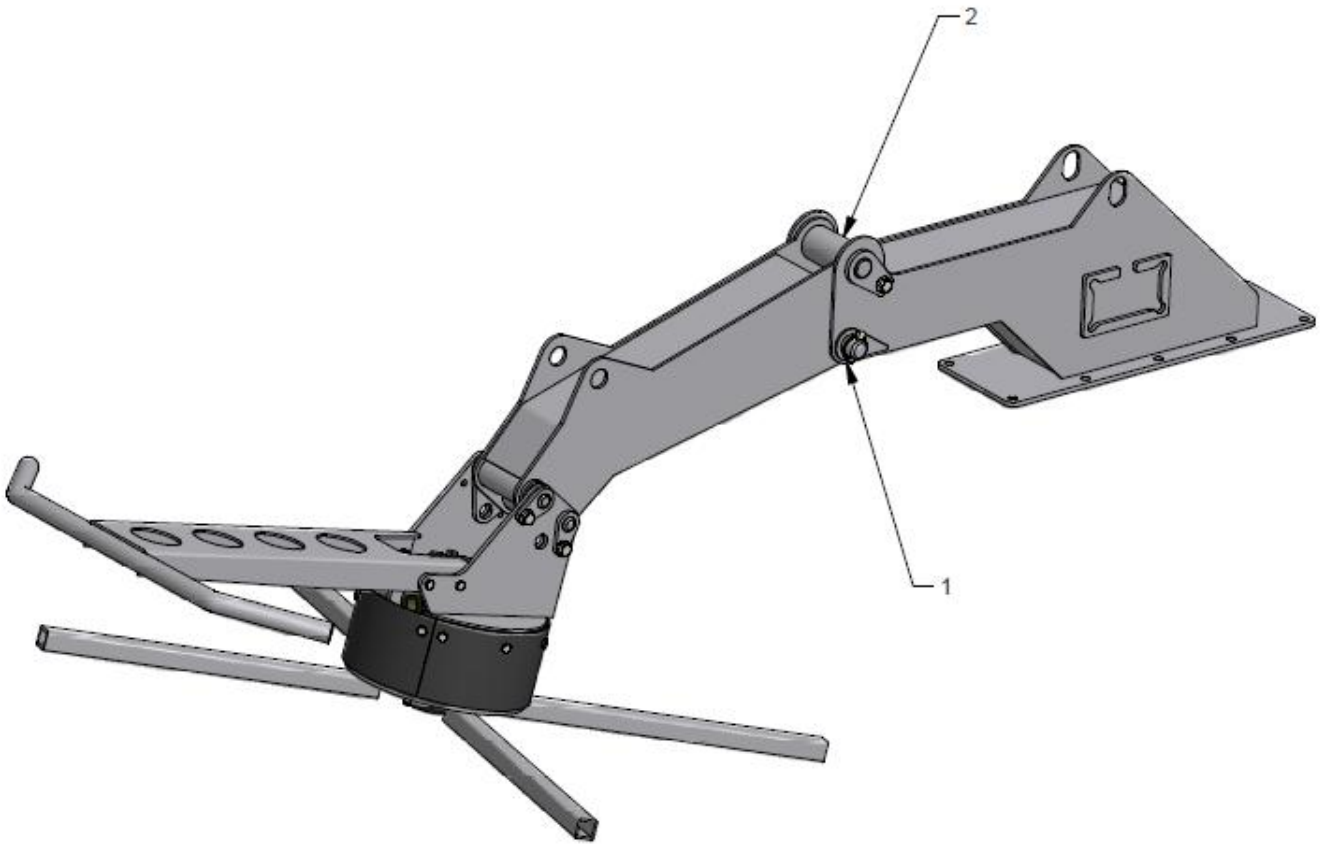

#	Item	Interval
1	Bottom Grease Boss	Every 100 Hours
2	Top Grease Boss	Every 100 Hours

Section 5

Maintenance

Complete all checks and services in this section at the hour interval shown.

IMPORTANT: Failure to complete the required maintenance at intervals shown can cause unnecessary downtime.

The recommended intervals are for average conditions. Perform maintenance more often when operating the Spreader Kit under adverse conditions.

Before performing any adjustments or maintenance on the Spreader Kit, observe these safety precautions:

1. Turn off tractor, set parking brake, remove key and wait for all moving parts to stop before leaving cab.

Failure to comply could result in death or serious injury.

Daily Maintenance

Careful inspection and service of the Spreader prior to operation each day will prevent needless breakdowns and delays in the field. Make the following checks and adjustments.

1. Be alert for loose hardware and tighten or replace as required.
2. Lubricate the Tube-Line Spreader Kit according to the instructions in the "Lubrication" section of this manual. Under adverse condition, shorten the lubrication intervals.
3. Check to make sure the Spinner Assembly is not loose and bolts are tight.

Preseason Service

Prior to beginning the harvest after off-season storage, take the following steps to be certain the Spreader is in good operating condition.

1. Check Spinner Assembly, make sure it is tight and that there is no play between it and the hydraulic motor.
2. Lubricate the Tube-Line Spreader Kit according to the “Lubrication” section of this manual.
3. Tighten or replace and damaged or missing fasteners.

End of Season Service

Prior to storing the Tube-Line Spreader Kit during the off season, follow these steps to ensure easier preparation for the next season and longer Tube-Line Spreader Kit life.

1. Pack all grease points with grease (see the “Lubrication” section for grease points location.)
2. Remove all crop material from the Tube-Line Spreader Kit

Trouble Shooting

Problem: Can not get desired spinner speed.

Solution 1: Check all connections for restrictions.

Solution 2: Make sure the tractor has 15 gal/min or more oil flow capacity.

Problem: Crop material does not spread out in a consistent pattern.

Solution 1: Readjust top deflector on accelerator and/or readjust spinner angle.

Problem: Crop material wraps around spinners.

Solution 1: Readjust spinner angle

TUBE•LINE™
MANUFACTURING LTD.